

- ### NOTES
1. Assume kerb and gullies in all areas where Swale drains, concrete channels, or Benny Block not shown.
 2. Filler Drains not shown.
 3. Side Road drainage to be confirmed.
 4. For typical road drainage outfall detail and section see Drawing 262701 / 190205

- ### KEY
- EXISTING**
- Watercourse To Be Retained
 - Watercourse To Be Abandoned
 - Culvert
- PROPOSED**
- Main Line Drainage - Catchment 'AA'
 - Main Line Drainage - Catchment 'AB'
 - Main Line Drainage - Catchment 'BA'
 - Main Line Drainage - Catchment 'BB'
 - Main Line Drainage - Catchment 'CA'
 - Main Line Drainage - Catchment 'CB'
 - Main Line Drainage - Catchment 'DA'
 - Main Line Drainage - Catchment 'DB'
 - Main Line Drainage - Catchment 'E'
 - Online Storage Tanks - Catchment 'AA'
 - Online Storage Tanks - Catchment 'AB'
 - Egerton Stream Diversion
 - Culvert Diversion (Changage 4420)
 - Grassed Channel
 - Toe Drain
 - Toe Drain with Face Drains 2m deep @ 10m c/c unless shown otherwise. (Spacing to be confirmed)
 - Concrete Channel
 - Combined Kerb Drainage
 - New Ditch
 - Stream Overflow Tank - Pump
 - Period / Oil Interceptor
 - Spill Tank
 - Valve
 - Pond Maintenance Access Track
 - Extended Detention Basin
 - Pond For Landscape Purposes
 - Sediment Forebay
 - Extent of Hydraulic Model Catchment

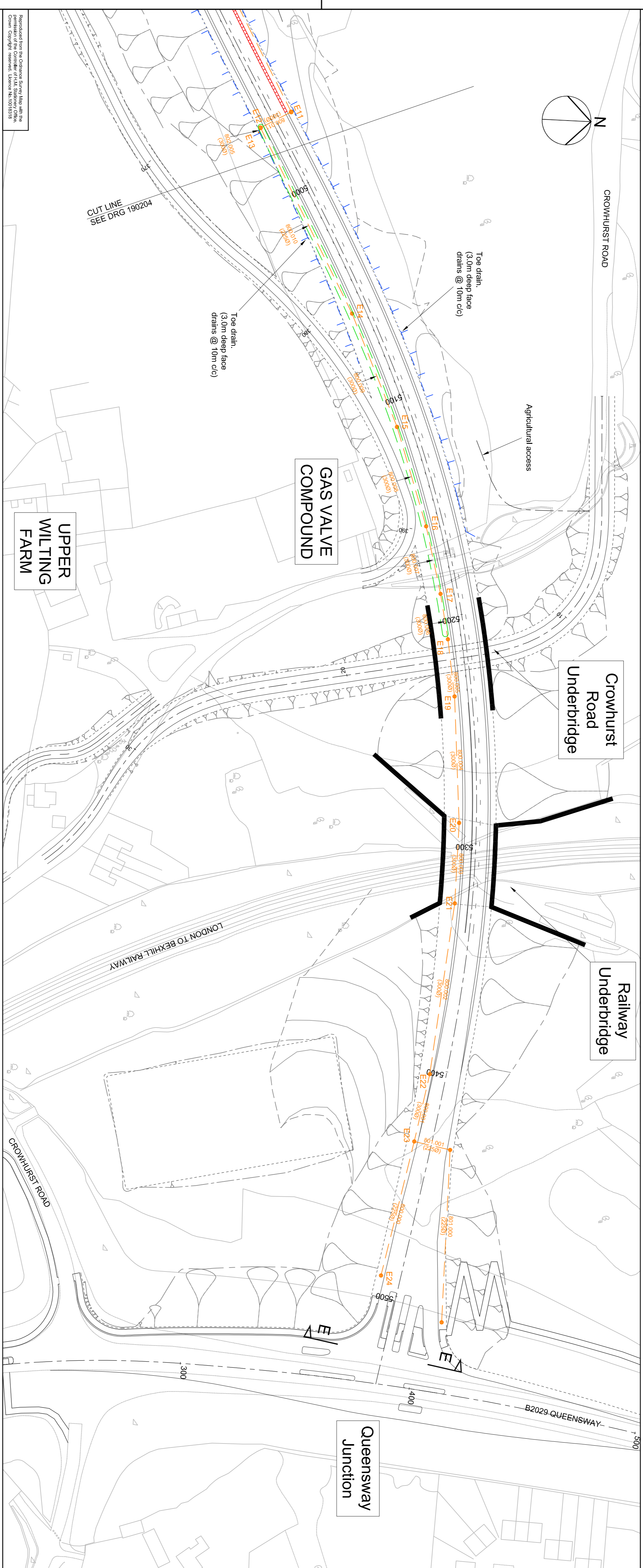

Rev	Chkd	Appld	Date

Drawn: BB	For comment
Chkd: BDB	For tender
Aspd: LB	For construction
Date: 27/02/2007	As constructed
File ref: g:\projects\major\projects\262701\behill\hastings\19	19 drawings\working\series 19

Owen Williams
Part of Arney plc

Client
EAST SUSSEX COUNTY COUNCIL
TRANSPORT AND ENVIRONMENT

Project Name
BEXHILL TO HASTINGS
LINK ROAD

Drawing Title
MODIFIED BLUE ROUTE
PLAN OF SCHEME USING
'SOFT' ENGINEERING OPTION
SHEET 5 OF 5

Original Drawing Size: A1
Scale: 1:1000
Dimensions: -

Drawing No
262701 / 190205

Rev	00

Produced from the Original Design Data in accordance with the provisions of the Copyright, Designs and Patents Act 1988. Owen Williams, London W8 1JN